

NOTES:

- MEASUREMENTS ARE IN METRES AND DECIMALS THEREOF.
- SOME MEASUREMENTS ARE APPROXIMATE AND MAY DIFFER FROM THE FINAL PLAN OF SURVEY BY AS MUCH AS 1.0 %.
- PORTION TO BE APPROVED IS OUTLINED WITH A BOLD DASHED LINE AND CONTAINS 0.49 ha (1.20 ac)
- TYPICAL CORNER CUTOFFS ARE 4.5 METRES.
- LOT WIDTHS SHOWN AS 6.74 ARE AT 6 METRE SETBACKS.

MARCH/21/2019
DATE

S. Rajakumar
SURESHKUMAR RAJAKUMAR
SASKATCHEWAN LAND SURVEYOR



OWNER:

CITY OF REGINA

CITY OF REGINA APPROVAL

THE SUBDIVISION PROPOSED HEREIN OUTLINED IN A BOLD DASHED LINE IS APPROVED UNDER THE PROVISIONS OF BYLAW NO. 7748-LA-B84 OF THE CITY OF REGINA.

DATED THIS ____ DAY OF _____ A.D. 20__.

CITY CLERK

**THE TOWNS - PHASE 1 STAGE 1GA
PLAN OF PROPOSED SUBDIVISION
OF PART OF
SW1/4 SEC 14, TWP 17, RGE 19, W2 Mer
REGINA, SASKATCHEWAN
2019**

SCALE = 1:1000

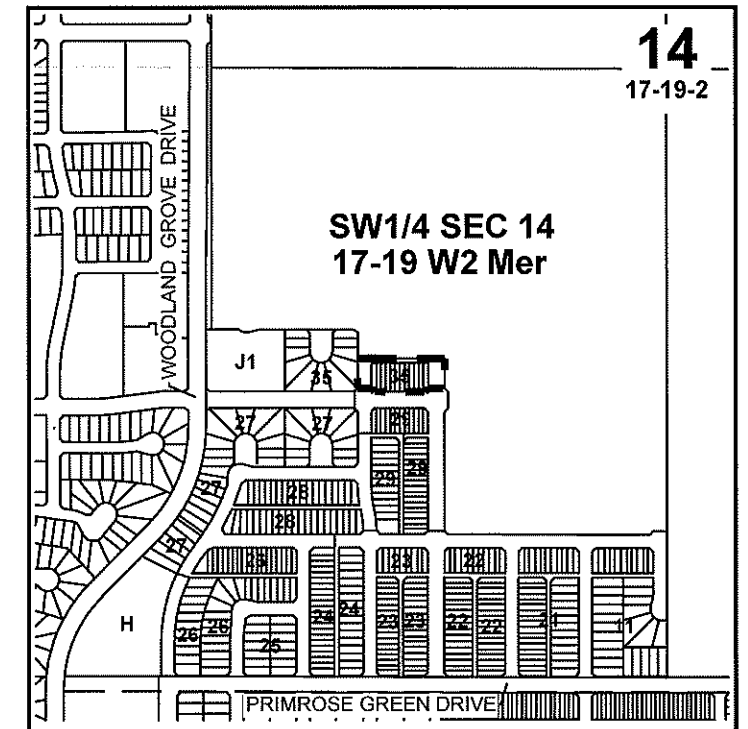
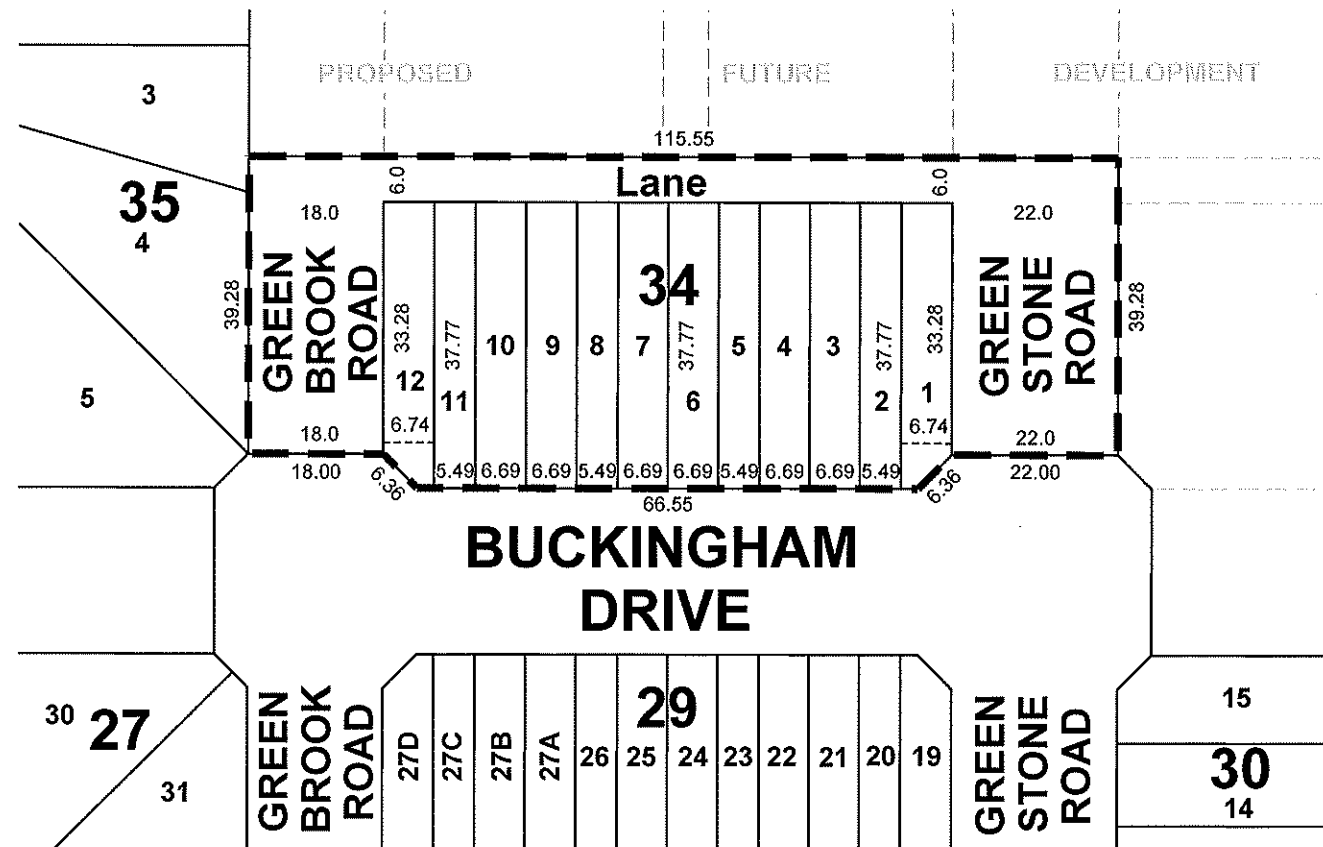

KEY PLAN



RC-0049-19-PPS
3/21/2019 2:13 PM