

LOT LEGEND

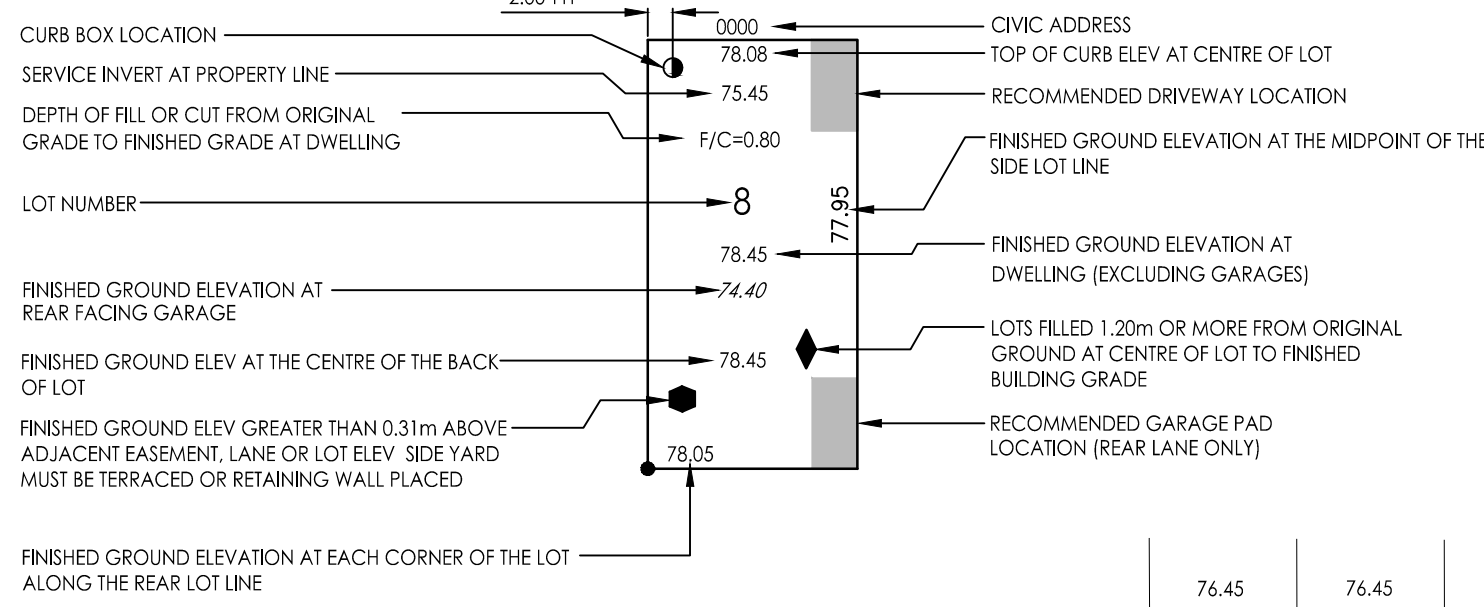

SERVICE CONNECTIONS

CURB BOXES SHALL BE LOCATED: a) 2.00m FROM THE SIDEYARD PROPERTY LINE FURTHEST FROM THE DRIVEWAY ALONG THE FRONT PROPERTY LINE OR AS NOTED. b) CORNER LOTS - 2.00m FROM THE INTERSECTION OF THE EXTENSION OF THE FRONT PROPERTY AND THE SIDEYARD PROPERTY LINE FURTHEST FROM THE DRIVEWAY ALONG THE FRONT PROPERTY LINE OR AS NOTED.

NOTE

IF BASEMENT EXCAVATION DOES NOT EXCEED THE FILL SHOWN ON THE BUILDING GRADE PLAN, THE BOTTOM OF THE EXCAVATION MUST BE TESTED TO DETERMINE THE BEARING CAPACITY. THIS TEST WILL BE DONE BY CONTACTING TERRA DEVELOPMENTS INC. 306-9246445

BENCH MARK

78V7257 GEODETIC DATUM NORTHING: 5584478.594, EASTING: 533657.461 ELEVATION 575.823 AUGER PIPE WITH BRASS CAP, AT NORTHEAST CORNER OF SECTION 5-17-19, 0.9 KM SOUTH OF HIGHWAY 33, 3.1 KM WEST OF CENTRE LINE OF SECTION ROAD, 20CM BELOW GROUND LEVEL. ESTABLISHED BY SASKATCHEWAN CENTRAL SURVEY AND MAP.

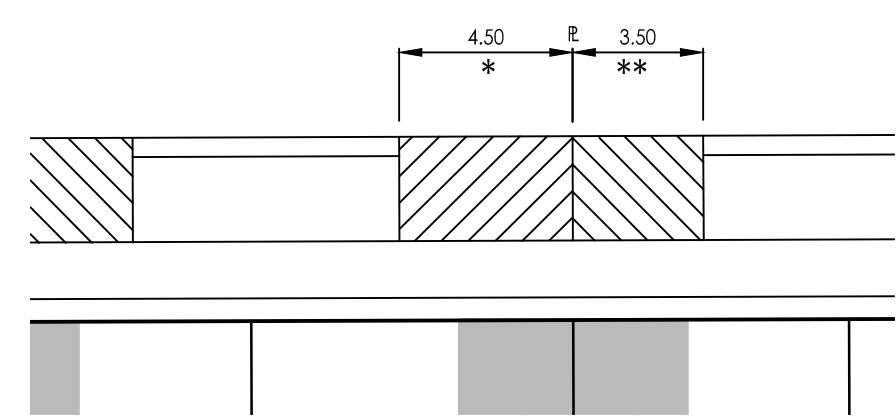

* LOTS 27, 28, 31, 32, 33, 35, 36, 37, 39 BLOCK 22 AND LOTS 3, 4, 5, 6, 11, 12, 13, 15, 16 BLOCK 23 TO HAVE 4.50m DRIVEWAY.

** LOTS 26, 29, 34, 38, 40 BLOCK 22 AND LOTS 2, 7, 10, 14 BLOCK 23 TO HAVE 3.50m DRIVEWAY.

TYPICAL RESIDENTIAL DRIVEWAY LOCATION (GREEN STONE ROAD)

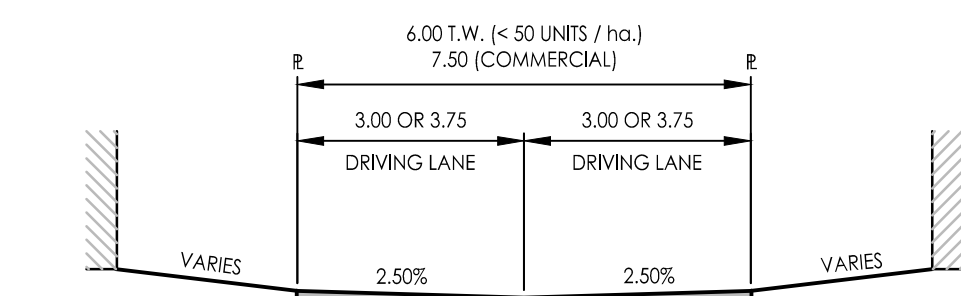

REAR YARD (WITH LANE) NTS

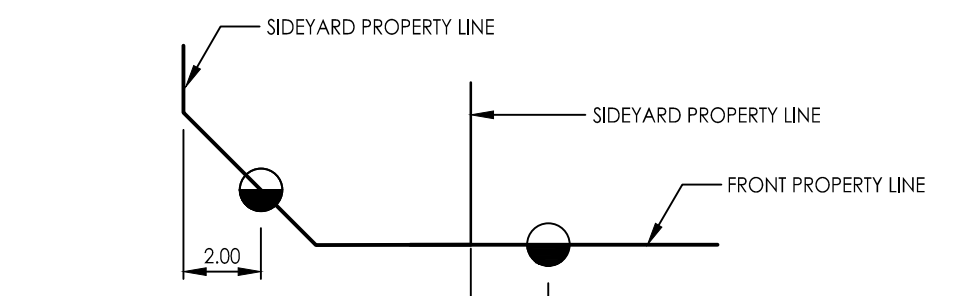

TYPICAL CURB BOX LOCATION DETAIL NTS

CORNER LOT TYPICAL DRIVEWAY LOCATION NTS

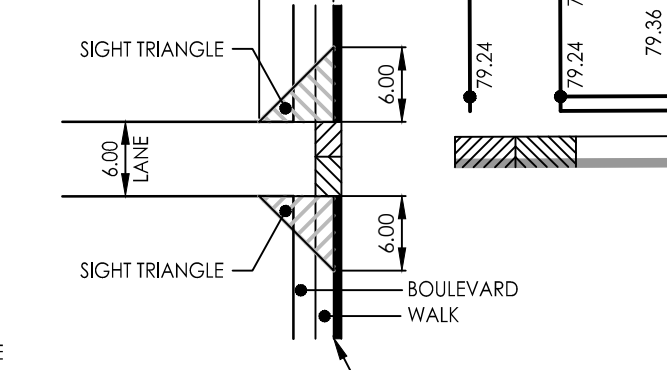
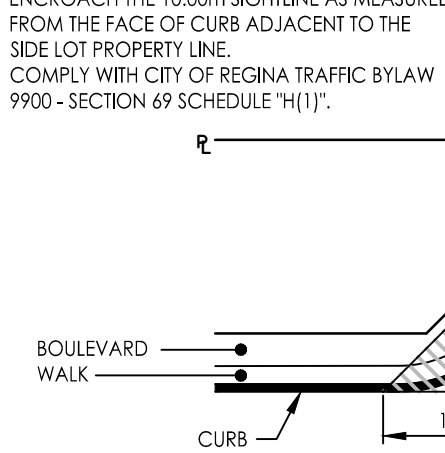

TYPICAL LANE/STREET INTERSECTION NTS

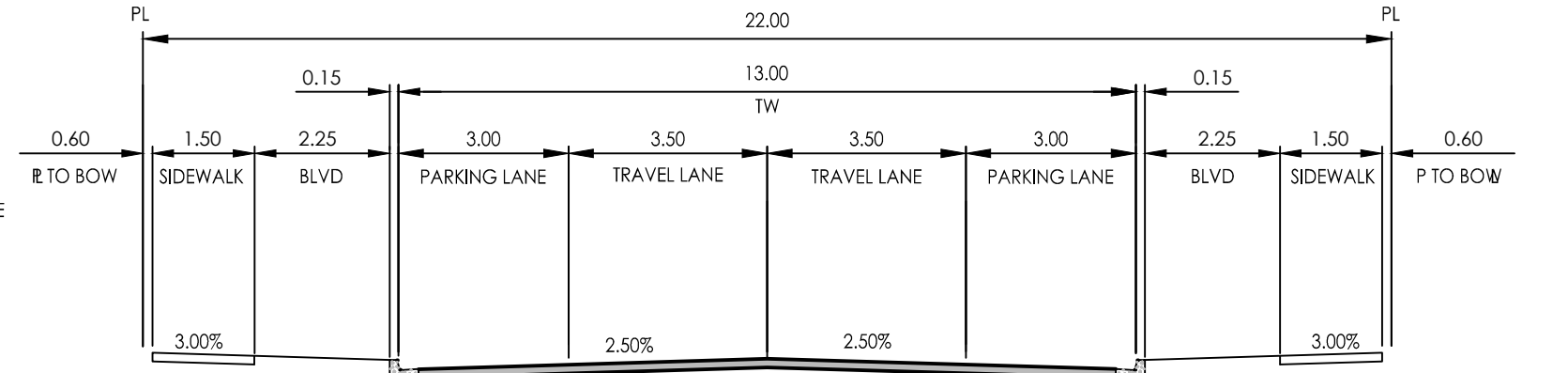

22.0m COLLECTOR (GREEN STONE ROAD) NTS

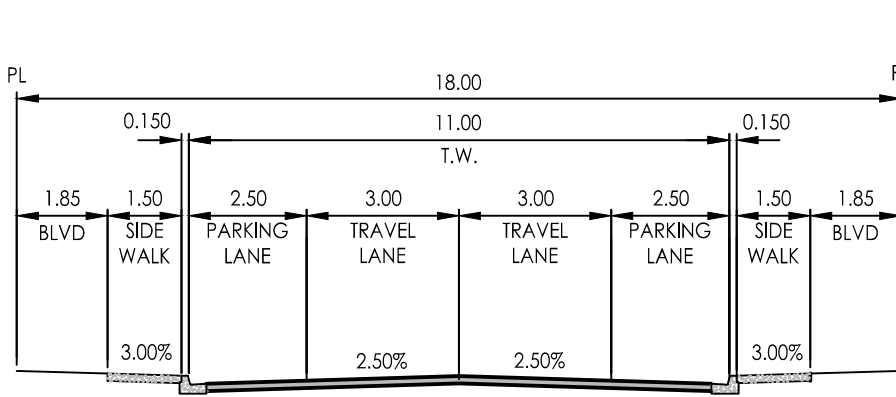

18.0m LOCAL RESIDENTIAL W/ MONO WALK NTS

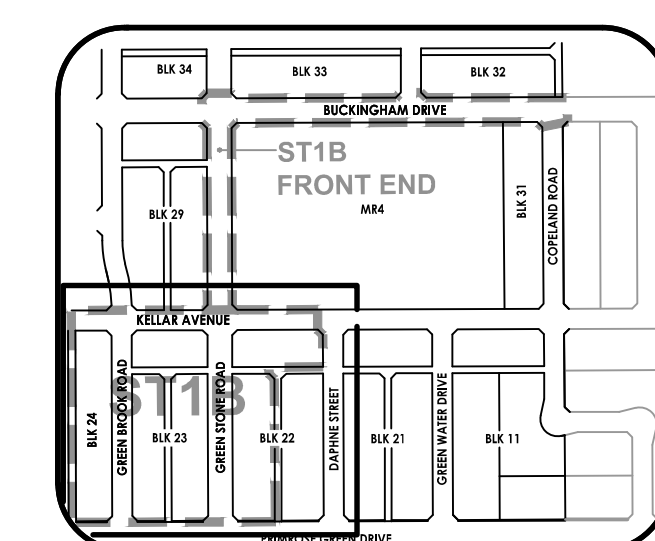
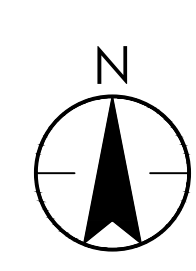
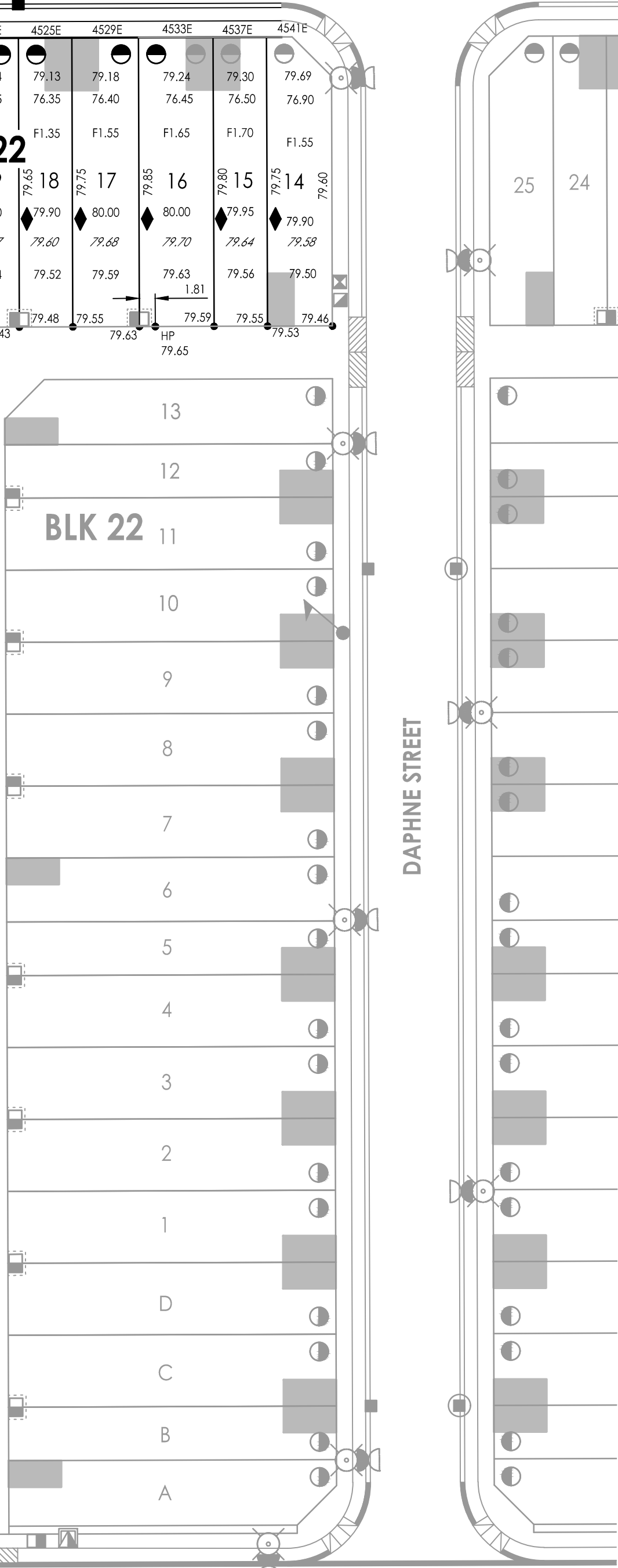
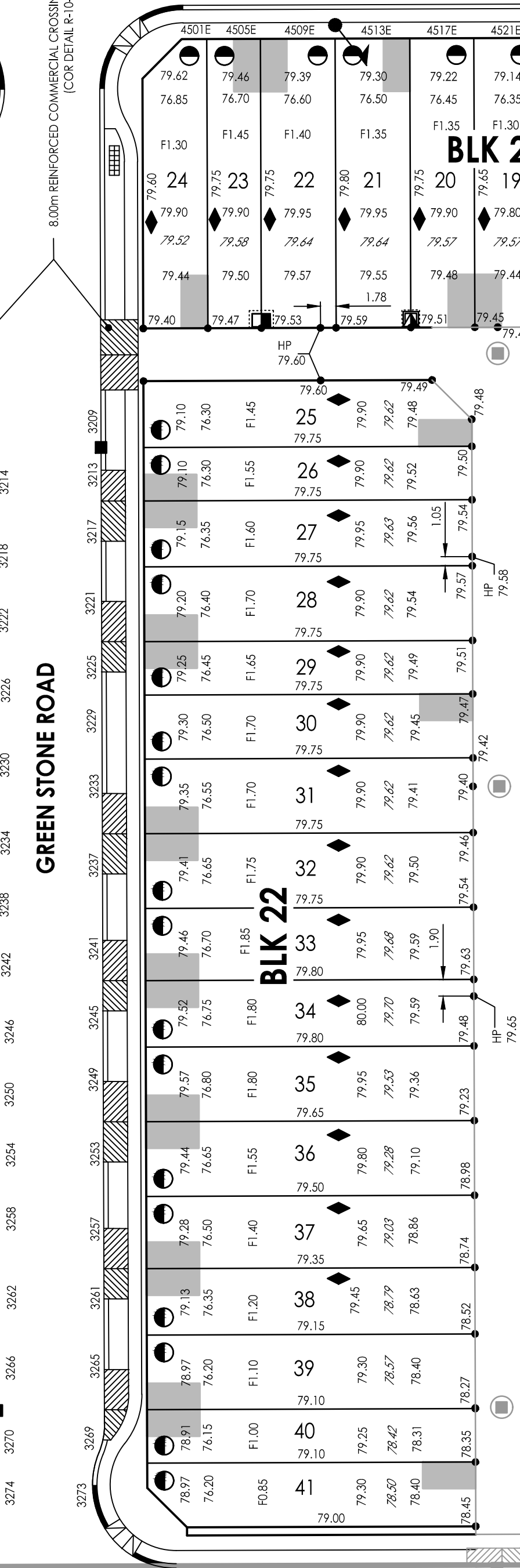
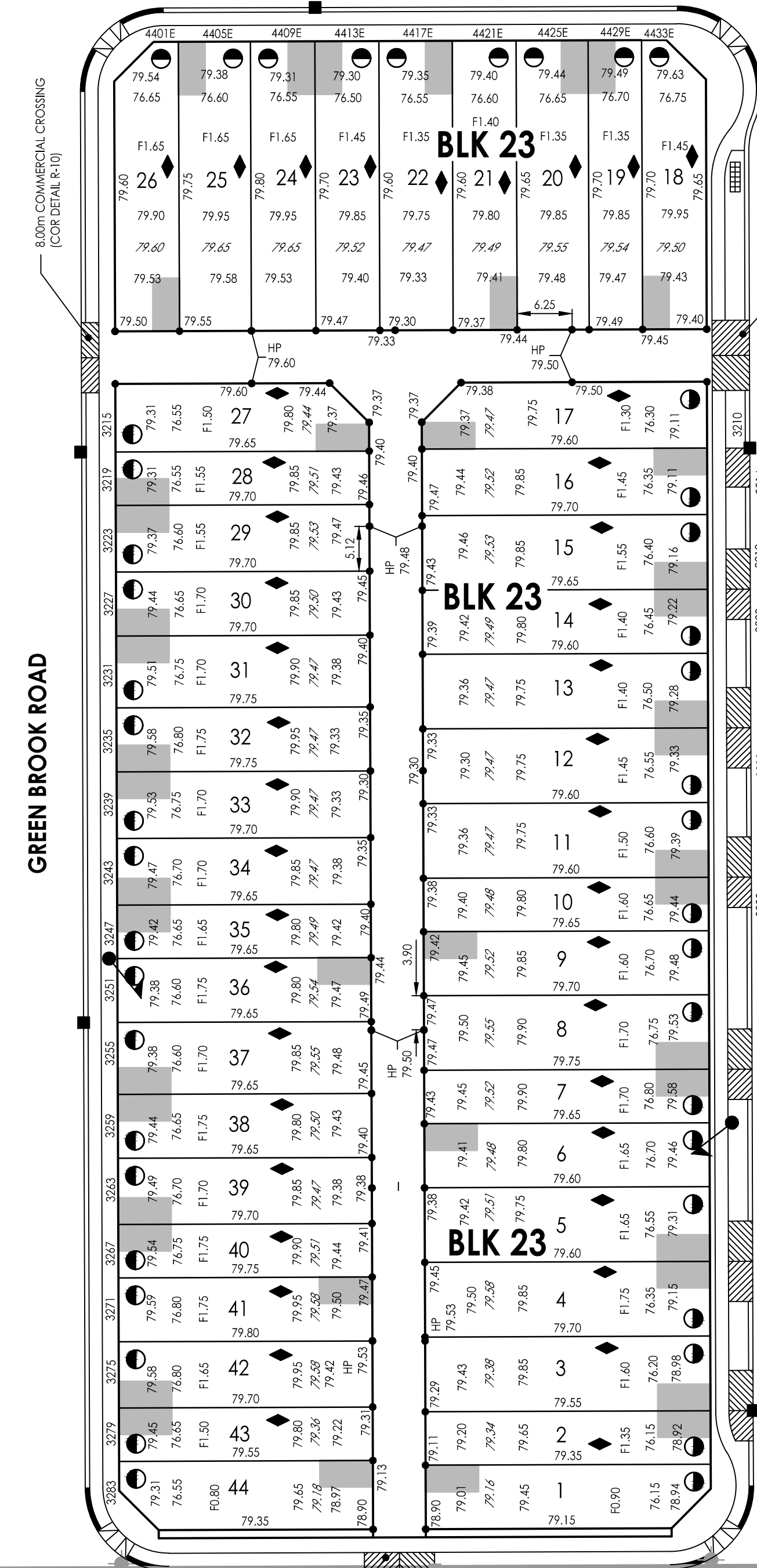
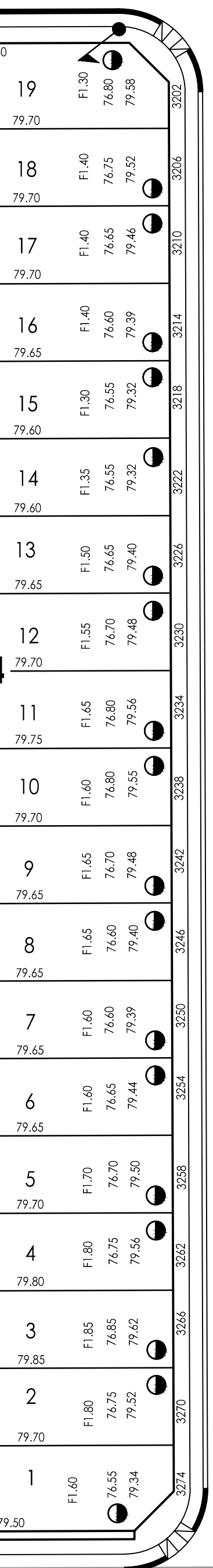
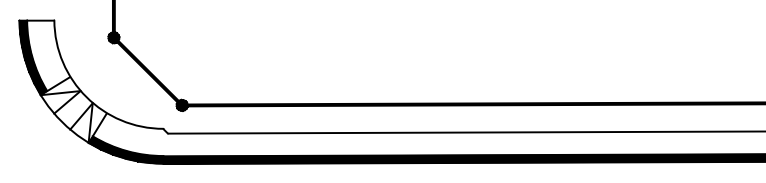
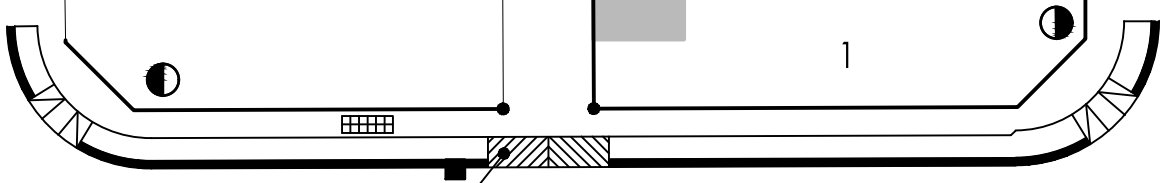
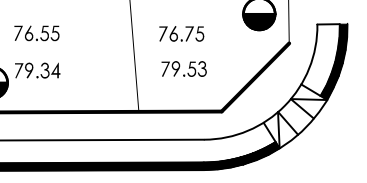

SHEET LOCATION PLAN



STANTEC CONSULTING LTD. 400 - 1820 Hamilton Street Regina, SK Canada S4P 2B8 Tel. 306.781.6350 Fax. 306.359.0233 www.stantec.com

Copyright Reserved

The Contractor shall verify and be responsible for all dimensions. DO NOT scale the drawing - any errors or omissions shall be reported to Stantec without delay. The Copyrights to all designs and drawings are the property of Stantec. Reproduction or use for any purpose other than that authorized by Stantec is forbidden.

Utility Disclaimer

Location of existing utilities as shown may not be exact or may be incomplete. Contractor to verify exact location of all utilities with appropriate authorities prior to starting construction. The developer and the consultant assume no responsibility for any utilities damaged during construction.

Legend

- SIDEWALK WITH BARRIER CURB
SIDEWALK WITH ROLLED CURB
BARRIER CURB
ROLLED CURB
ORIGINAL CONTOURS
SASKPOWER TRANSFORMER
SASKPOWER PEDESTAL
SASKTEL PEDESTAL
CATV PEDESTAL
CATCHBASIN/MANHOLE
CATCHBASIN
FIRE HYDRANT
POST TOP STREET LIGHT
COBRA HEAD STREET LIGHT
SUPER MAIL BOX
HIGH POINT
SERVICE LOCATION
SERVICE STUBBED 3.00m INTO PROPERTY
EASEMENT

Notes

- 1. ALL MATERIALS AND CONSTRUCTION TO COMPLY WITH CURRENT CITY OF REGINA STANDARD CONSTRUCTION SPECIFICATIONS AND DETAILS.
2. ADD 500m FOR GEODETIC ELEVATION.

Table with 4 columns: Revision, Description, By, Appd. Includes revisions for approval, agreement, and review.

Permit/Seal

Association of Professional Engineers & Geoscientists of Saskatchewan CERTIFICATE OF AUTHORIZATION STANTEC CONSULTING LTD.

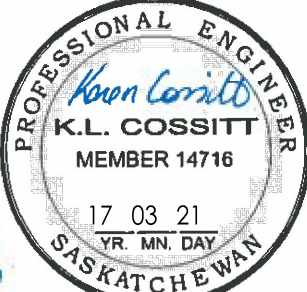

Discipline: Sk. Reg. No. 14716, Signature: Kuan Corbett

Client/Project

TERRA DEVELOPMENTS INC. THE TOWNS SUBDIVISION PHASE 1 - STAGE 1B SITE SERVICES Regina, Saskatchewan

Title

LOT GRADING

Project No. 1131-01205 Scale 0 5 15 25m

Drawing No. C-2 Sheet 2 of 18 Revision 5